

PLUGUES E TOMADAS INDUSTRIAIS

Para conexões elétricas temporárias em aplicações que requerem correntes elevadas, alta resistência mecânica e proteção contra a penetração prejudicial de água e objetos sólidos.

Construção de acordo com a norma ABNT NBR IEC 60309

Capacidades de 16A, 32A ou 63A

Versões 2P+T, 3P+T ou 3P+N+T

Grau de proteção IP44 ou IP67 conforme modelo



ESPECIFICAÇÕES

Temperatura ambiente de operação: De -20°C a 45°C

Resistência ao calor anormal e ao fogo: 650°C ⁽¹⁾ e 850°C ⁽²⁾

Frequência de operação: 50/60Hz

Bornes de conexão	
Corrente nominal	Bitola dos cabos
16A	2,5 a 4,0mm ²
32A	4,0 a 6,0mm ²
63A	10,0 a 16,0mm ²

⁽¹⁾ Para partes isolantes não responsáveis por manter em posição as partes condutoras de corrente, de acordo com a Norma ABNT NBR IEC 60309.

⁽²⁾ Para partes isolantes responsáveis por manter em posição as partes condutoras de corrente, de acordo com a Norma ABNT NBR IEC 60309.

PLUGUES INDUSTRIAIS MÓVEIS

MODELOS	POLOS	CORRENTE NOMINAL	POSIÇÃO DO PINO TERRA*		GRAU DE PROTEÇÃO
			Azul 200/250V~	Vermelho 380/440V~	
PLN3-16M	2P+T	16A	6H	9H	IP44
PLN3-32M		32A	6H	9H	IP44
PLN3-63M		63A	6H	9H	IP67
PLN4-16M	3P+T	16A	9H	6H	IP44
PLN4-32M		32A	9H	6H	IP44
PLN4-63M		63A	9H	6H	IP67
PLN5-16M	3P+N+T	16A	9H	6H	IP44
PLN5-32M		32A	9H	6H	IP44
PLN5-63M		63A	9H	6H	IP67

*Posição de pino terra (vista frontal) - Plugues

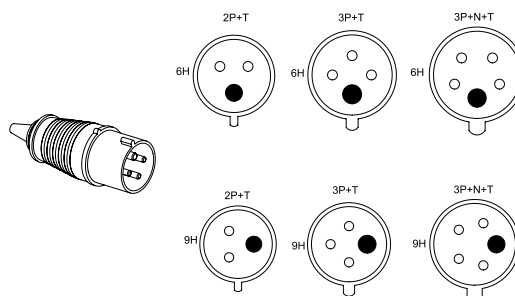

DIMENSIONAIS

PLN3-16M e PLN3-32M

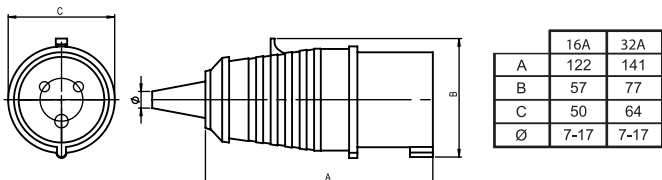

PLN4-16M e PLN4-32M

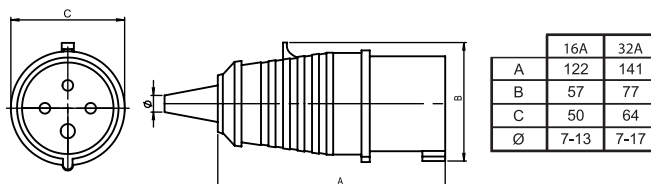

PLN3-63M

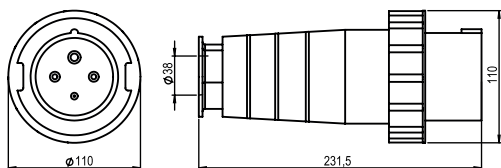

PLN4-63M

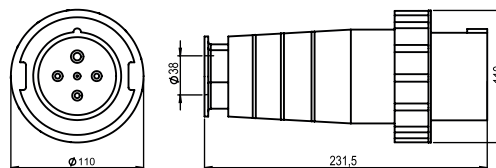

PLN5-16M e PLN5-32M

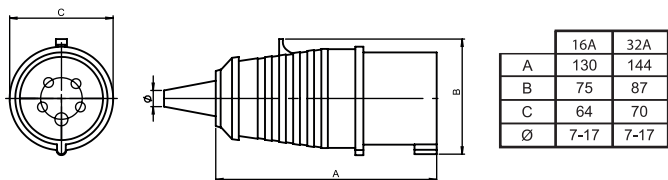

PLN5-63M

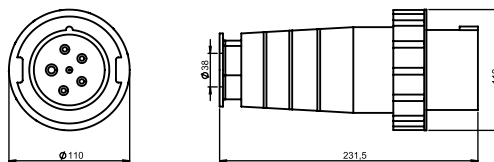

TOMADAS INDUSTRIAIS MÓVEIS

MODELOS	POLOS	CORRENTE NOMINAL	POSIÇÃO DO CONTATO TERRA*		GRAU DE PROTEÇÃO
			Azul 200/250V~	Vermelho 380/440V~	
TMI3-16M	2P+T	16A	6H	9H	IP44
TMI3-32M		32A	6H	9H	IP44
TMI3-63M		63A	6H	9H	IP67
TMI4-16M	3P+T	16A	9H	6H	IP44
TMI4-32M		32A	9H	6H	IP44
TMI4-63M		63A	9H	6H	IP67
TMI5-16M	3P+N+T	16A	9H	6H	IP44
TMI5-32M		32A	9H	6H	IP44
TMI5-63M		63A	9H	6H	IP67

*Posição do contato terra (vista frontal) - Tomadas

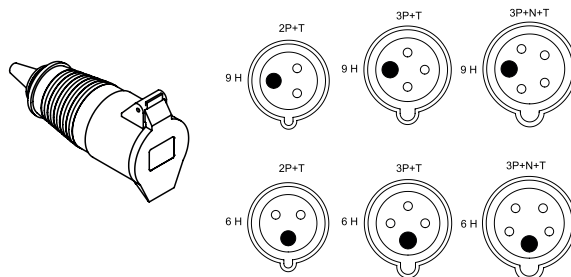

DIMENSIONAIS

TMI3-16M e TMI3-32M

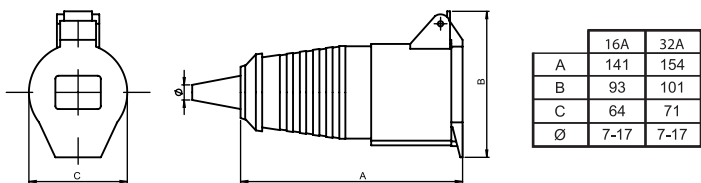

TMI4-16M e TMI4-32M

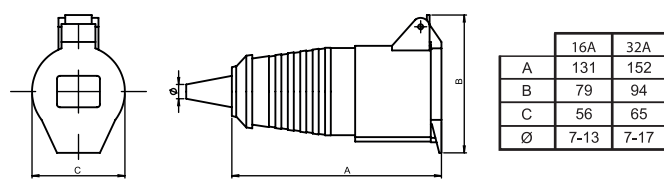

TMI3-63M

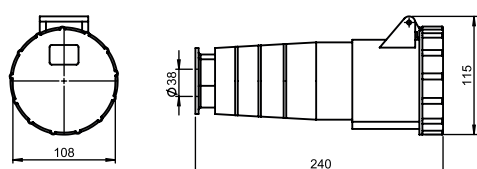

TMI4-63M

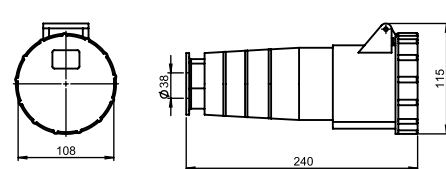

TMI5-16M e TMI5-32M

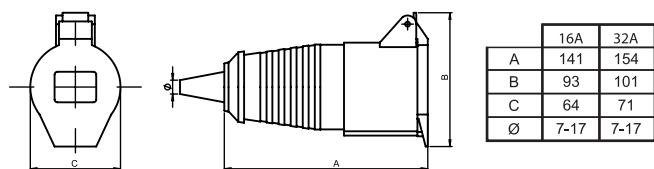

TMI5-63M

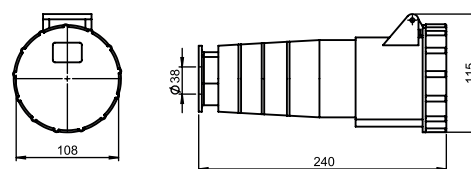

TOMADAS INDUSTRIAIS FIXAS DE SOBREPOR

MODELOS	POLOS	CORRENTE NOMINAL	POSIÇÃO DO CONTATO TERRA*		GRAU DE PROTEÇÃO
			Azul 200/250V~	Vermelho 380/440V~	
TMI3-16S	2P+T	16A	6H	9H	IP44
TMI3-32S		32A	6H	9H	IP44
TMI3-63S		63A	6H	9H	IP67
TMI4-16S	3P+T	16A	9H	6H	IP44
TMI4-32S		32A	9H	6H	IP44
TMI4-63S		63A	9H	6H	IP67
TMI5-16S	3P+N+T	16A	9H	6H	IP44
TMI5-32S		32A	9H	6H	IP44
TMI5-63S		63A	9H	6H	IP67

*Posição do contato terra (vista frontal) - Tomadas

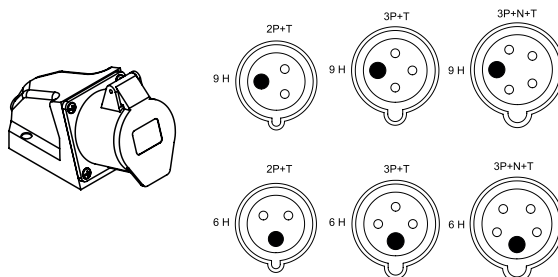

DIMENSIONAIS

TMI3-16S e TMI3-32S

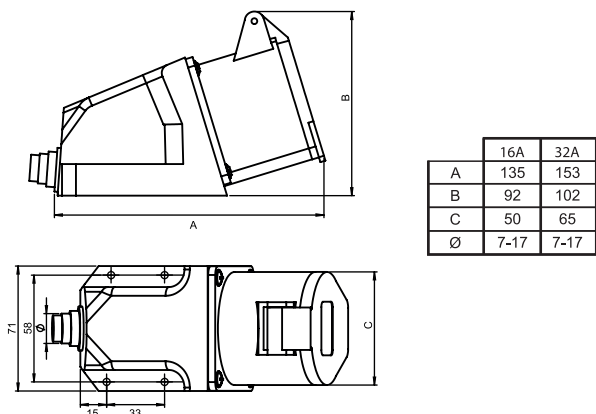

TMI4-16S e TMI4-32S

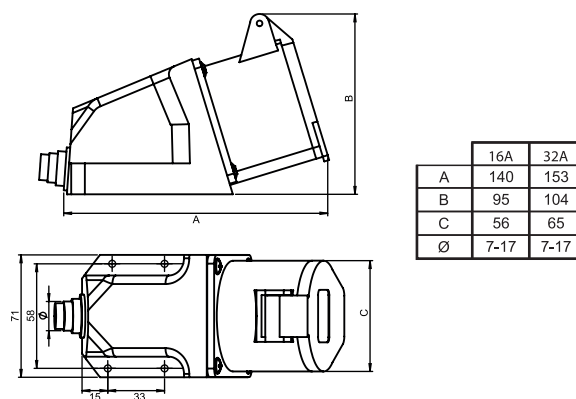

TMI3-63S

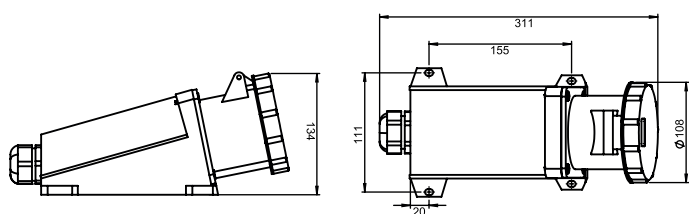

TMI4-63S

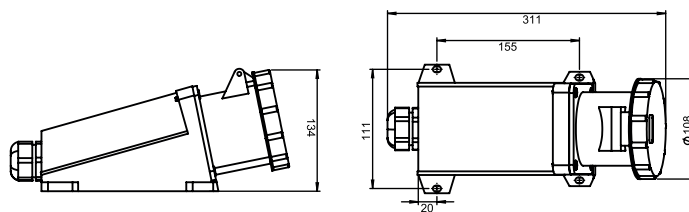

TMI5-16S e TMI5-32S

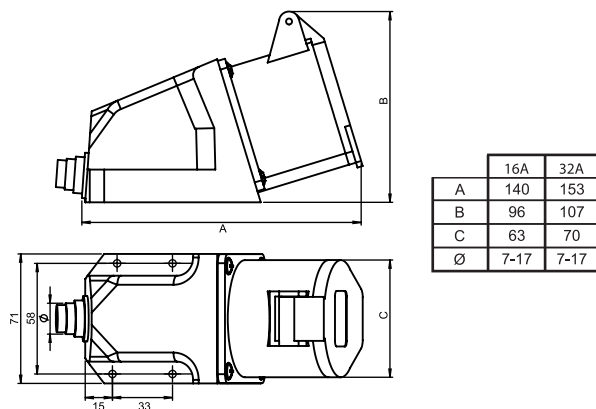

TMI5-63S

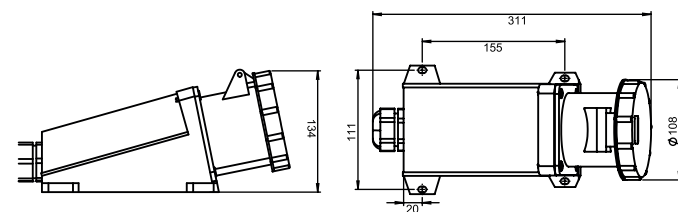

TOMADAS INDUSTRIAIS FIXAS DE EMBUTIR

MODELOS	POLOS	CORRENTE NOMINAL	POSIÇÃO DO CONTATO TERRA*		GRAU DE PROTEÇÃO
			Azul 200/250V~	Vermelho 380/440V~	
TMI3-16E	2P+T	16A	6H	9H	IP44
TMI3-32E		32A	6H	9H	IP44
TMI3-63E		63A	6H	9H	IP67
TMI4-16E	3P+T	16A	9H	6H	IP44
TMI4-32E		32A	9H	6H	IP44
TMI4-63E		63A	9H	6H	IP67
TMI5-16E	3P+N+T	16A	9H	6H	IP44
TMI5-32E		32A	9H	6H	IP44
TMI5-63E		63A	9H	6H	IP67

*Posição do contato terra (vista frontal) - Tomadas

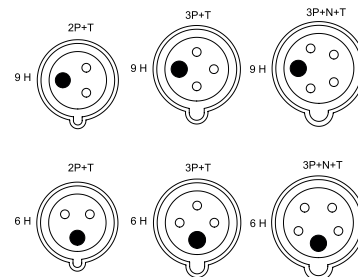
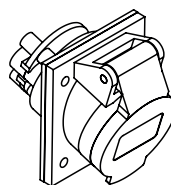

DIMENSIONAIS

TMI3-16E e TMI3-32E

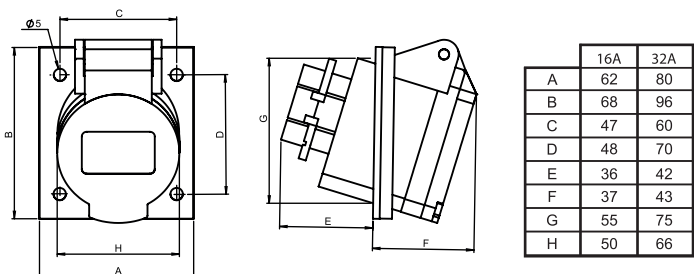

Furos para fixação:

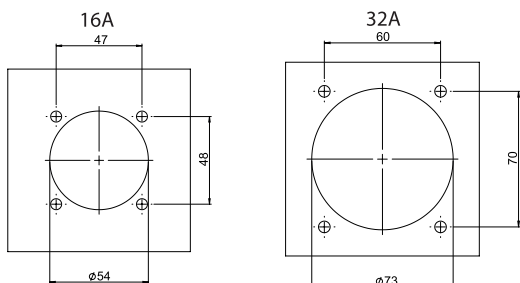

TMI4-16E e TMI4-32E

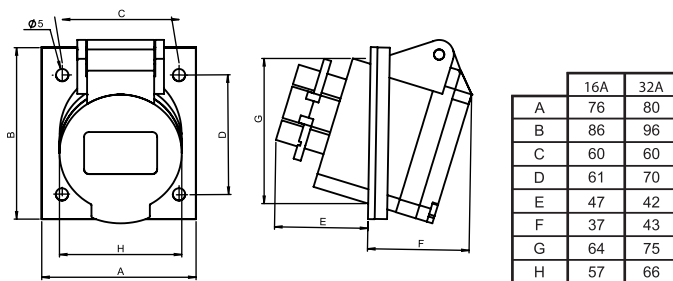

Furos para fixação:

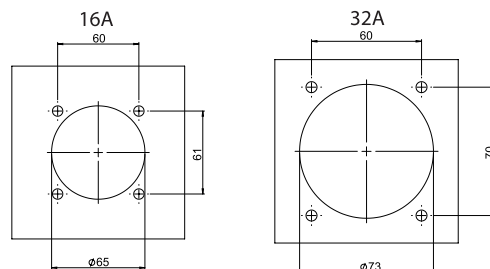

TMI3-63E

Furos para fixação:

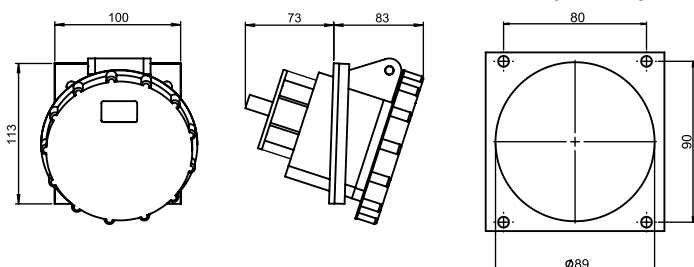

TMI4-63E

Furos para fixação:

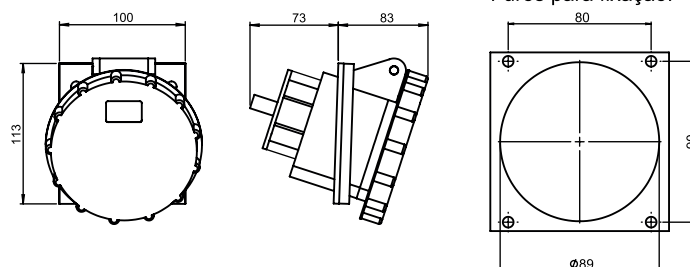

TMI5-16E e TMI5-32E

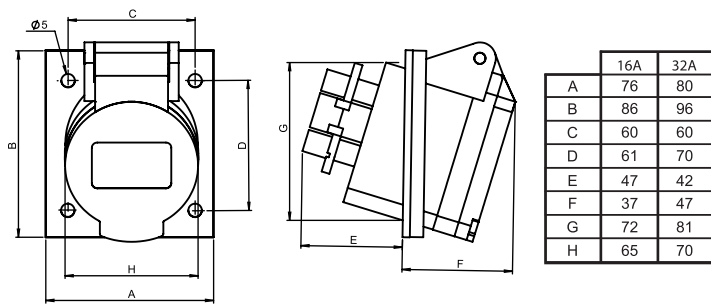

Furos para fixação:

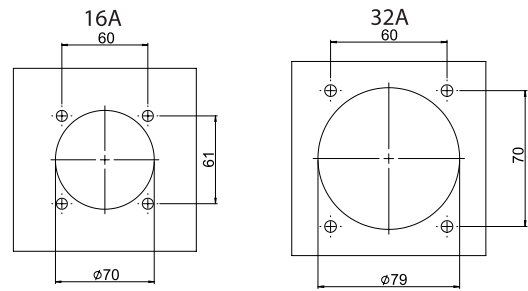



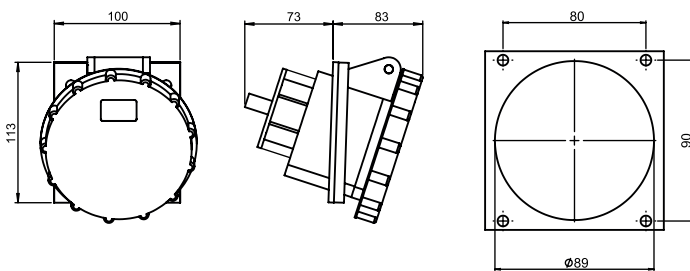

TMI5-63E

Furos para fixação:



BARRA DE CODIFICAÇÃO

 Produto PLN - Plugue industrial TMI - Tomada industrial	 Polos 3 - 2P+T 4 - 3P+T 5 - 3P+N+T	 Corrente nominal 16 - 16A 32 - 32A 63 - 63A	 Configuração E - Embutir S - Sobrepor M - Móvel	Cor e tensão* Azul (200/250V~) Vermelho (380/440V~)	Posição do terra* 9H 6H	Grau de proteção* IP44 IP67
--	--	---	---	---	-------------------------------	-----------------------------------

*As combinações de cores, tensões, posições do pino/contato terra e graus de proteção disponíveis constam nas tabelas correspondentes. Para outras opções, consulte nossa área comercial.