

SWITCHGEARS SERIES

MOTOR SWITCHES

electric
controls

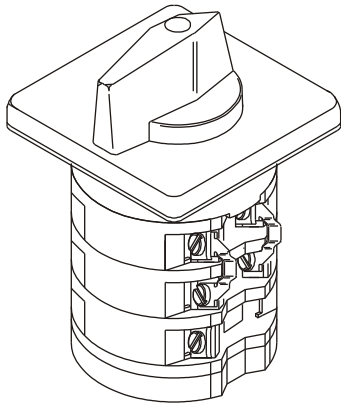

HOW TO SELECT

AC1-AC21 - slightly inductive loads $\text{COS} = 0,95$ both intensity nominal or the used one have the same value.

AC2-AC22 - inductive loads $\text{COS} = 0,65$

AC3-AC23 - strongly inductive loads $\text{COS} = 0,35-0,65$, direct motors start, disconnection with load.

AC4 - strongly inductive loads which are made of motor, lockwire against current and reversion.

DIMENSIONS

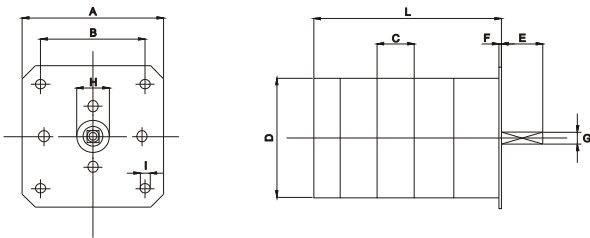

CAM SWITCHES	L mm for elements numbers						
	1	2	3	4	5	6	7
MG 16/20	48	62	76	90	104	118	132
MG 32/40	51	68	85	102	119	136	153

CAM SWITCHES	Dimensions in mm								
	A	B	C	D	E	F	G	H	I
MG 16/20	65	48	9	55	19	1,2	5,5	15	4,3
MG 32/40	65	48	12	55	19	1,2	5,5	15	4,3

REFERENCES AND CAPACITIES IN HP

REF.	CATEGORY		ONE-PHASE		THREE-PHASE		
			110V	220V	220V	380V	440V
MG-16 (16A)	AC 1	AC 21	2,3	4,5	7,9	13,6	15,6
	AC 2	AC 22	-	-	3,7	5,5	5,7
	AC 3	AC 23	1	2	3,5	5,5	5,7
	AC 4		1	2	1,4	2,2	2,3
MG-20 (20A)	AC 1	AC 21	2,8	5,7	9,8	16,9	19,5
	AC 2	AC 22	-	-	6	10	11
	AC 3	AC 23	1,5	3	4,5	7,5	8
	AC 4		1,5	3	1,8	3	3,2
MG-32 (32A)	AC 1	AC 21	4,5	9	15,7	27,2	31,2
	AC 2	AC 22	-	-	9,5	15	15,5
	AC 3	AC 23	2,3	4,5	7,5	13,5	13,5
	AC 4		2,3	4,5	3	5,4	5,4
MG-40 (40A)	AC 1	AC 21	5,7	11,4	19,5	34	39
	AC 2	AC 22	-	-	13,5	22	22,5
	AC 3	AC 23	3	6	11,5	20	20,5
	AC 4		3	6	4,6	8	8,2

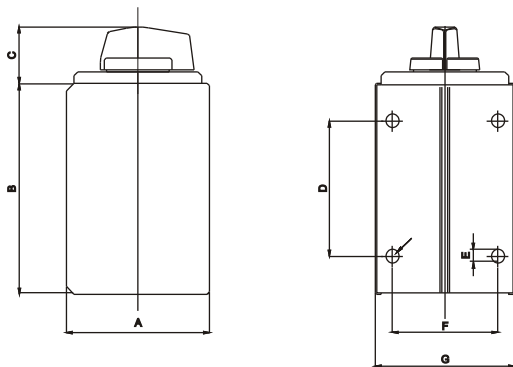

IRON BOX	Dimensions in mm						
	A	B	C	D	E	F	G
up to 3 elements	74	109	30	70	7	54,6	72
up to 4 elements	74	137	30	102	7	50	72
up to 7 elements	75	200	30	162	7	68,3	84

To choose cam switches in iron box, add "C/C" in the end of the product code.

FIXATION

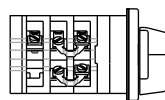

Top fixing

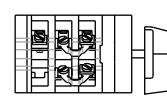

Frontal fixing:
remove the fixing board.

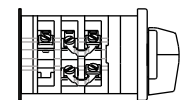

Base fixing:
Remove the former fixing board and mount it in the latter part of cam switch.

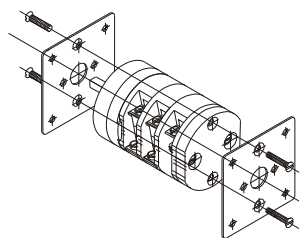

ADAPTATION OF FIXING BOARD

You can fix our cam switches either by top or other mean which you choose.

SELECTION GUIDE



Reference



application



box

SWITCHGEARS SERIES

APPLICATIONS

The switchgears allow the most varied configurations. Below they are illustrated with the most common functions.

Specific wiring can be requested by e-mail tecnico@margirius.com.br or by phone 55 19 3589 5000.

TR - Transference switch
(3 Chambers)

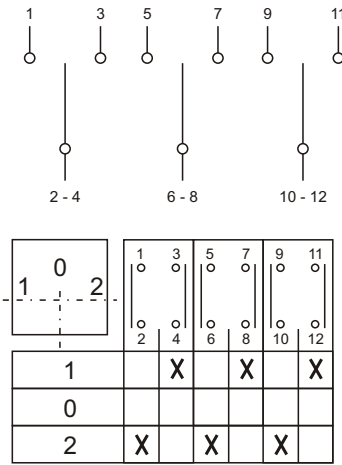

CET - Star delta switch
(4 Chambers)

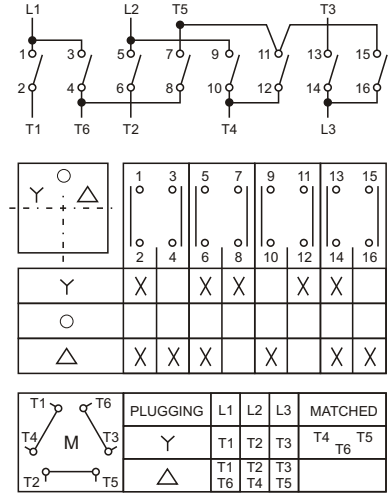

CS - ON/OFF
(2 Chambers)

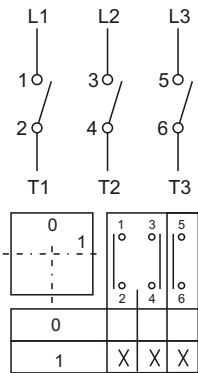

CV - Voltmeter switch
(2 Chambers)

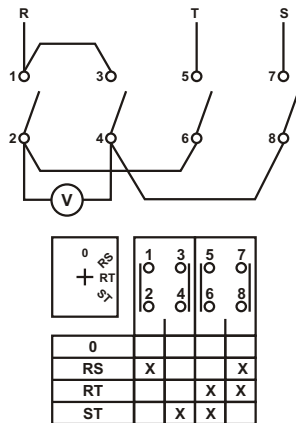

CA - Ammeter switch
(2 Chambers)

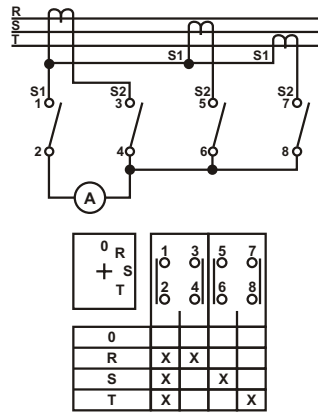

CR - Reverse with 0 in the middle
(3 Chambers)

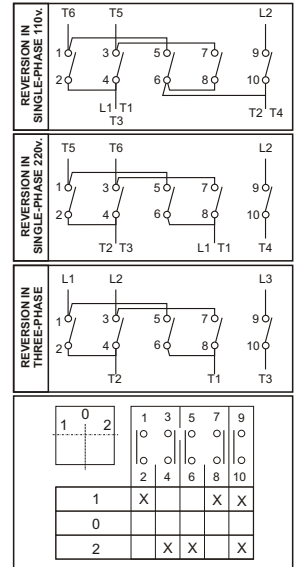

C2R - Dahlander with 2 rotations and 0 in the middle
(4 chambers)

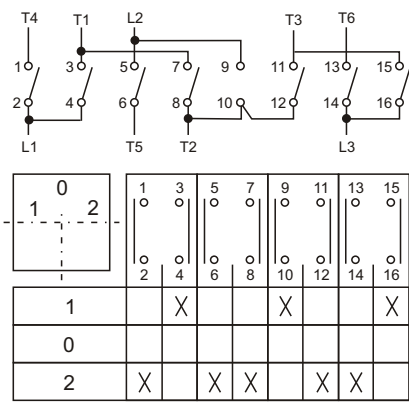

C2RR - Dahlander with 2 rotations, reverse and 0 in the middle
(7 chambers)

