

# HHM SERIES

## SLIDE SWITCHES

### SPECIFICATIONS:

**ELECTRICAL CHARACTERISTICS** : 2A 250V~ (without comutation) or 0,5A 250V~ (comutation in resistive load).

**CONTACT RESISTANCE**: maximum of 20 miliohms with application of 1A in VCC.

**INSULATION RESISTANCE**: minimum of 1.000 megaohms.

**DIELECTRIC WITHSTAND**: 1.000V(RMS) for 1 minute (minimum).

**OPERATION TEMPERATURE**: from 0°C to 55°C.

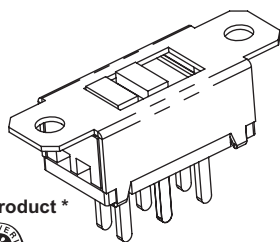

Certified Product \*



OCP 0018

NBR IEC 61058-1

\* Call us

## REFERENCES

Reference			Poles
HHM - 101	On	On	One-pole
HHM - 201	On	On	Double-pole

### HH-101

SF - without borders

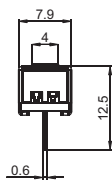
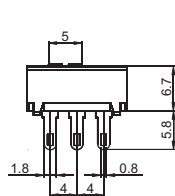

SF1 - with borders

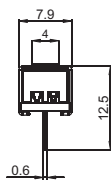
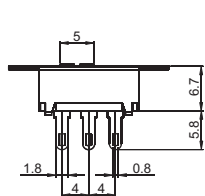

### HH-201

SF - without borders

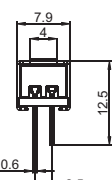
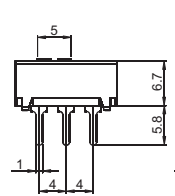

SF1 - with borders

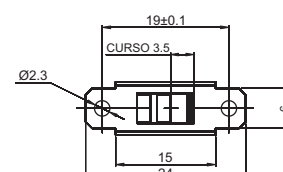
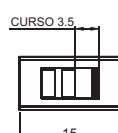
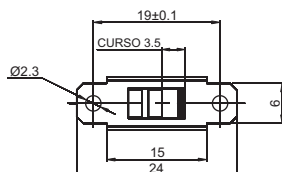
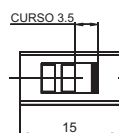
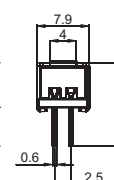
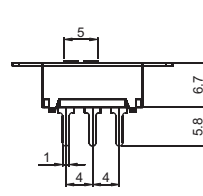

## FASTENING

SF - without borders

SF1 - with borders and holes of 2,3mm (standard)

## ACTUATORS

A1#

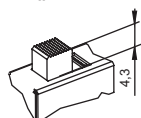

A2#

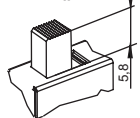

A3#

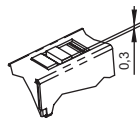

Note:

G3# - Actuator A3 with 110-220 marking

G4# - Actuator A3 with 127-220 marking

## TERMINALS

S1 - solder

CI - PC

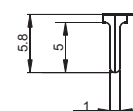
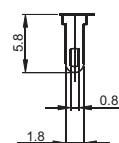

## CONTACTS

S - Standard

2A 250V~ (without comutation in resistive load).

0,5A 250V~ (with comutation in resistive load).

## # - COLORS

Note: Substitute # by the code of requested color.

- A - blue
- B - white
- C - yellow
- D - green
- E - red
- F - black - (standard)
- G - gray
- H - brown

## SELECTION GUIDE



Reference



Fastening  
SF  
SF1



Actuator  
A1#  
A2#  
A3#  
G3#  
G4#



terminal  
S1  
CI



Contact  
S