

29.100 SERIES

ROCKER SWITCHES

SPECIFICATIONS:

ELECTRICAL CHARACTERISTICS : 15A with resistive load 120VAC or 10A with resistive load 250VAC. (Q contact)

CONTACT RESISTANCE: maximum of 20 miliohms with 1A DC.

INSULATION RESISTANCE: minimum of 1.000 megaohms.

DIELECTRIC WITHSTAND: 1.000V(RMS) for 1 minute (minimum).

OPERATION TEMPERATURE: from 0° to 55°C.



REFERENCES

Reference		
29101	ON	ON
* 29123	ON	OFF
29129	ON	(OFF)

* Possible options with lamp 110/250 VAC.
Note: For other tensions call us.

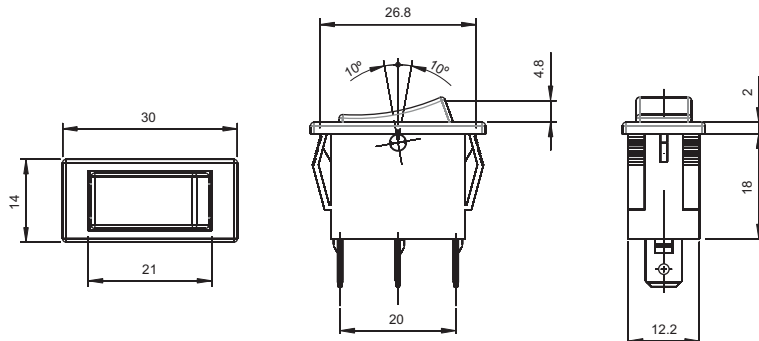

FRAMES

M1# - 14,0 x 30,0 (Standard)

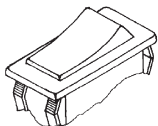

M3# - 16,0 x 31,0

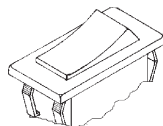

M4# - with cover

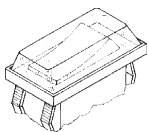

ACTUATORS

T1# - rocker illuminated

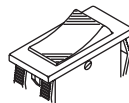

T2# - rocker



T3# - rocker illuminated

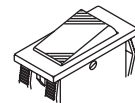

T4# - rocker

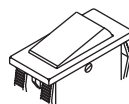

T5## - rocker with lens

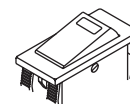

T6## - rocker illuminated

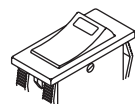

TERMINAL

E3 - faston 6,3 x 0,8

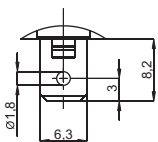

CONTACTS

S - Standard
4A with resistive load 120VAC
2A with resistive load 250VAC
B
10A with resistive load 120VAC
6A with resistive load 250VAC
Q
15A with resistive load 120VAC
10A with resistive load 250VAC
G
20A with resistive load 120VAC
15A with resistive load 250VAC

- COLORS

Note: Substitute # by the code of requested color.

- A - blue
- B - white
- C - yellow
- D - green
- E - red
- F - black - (standard)
- G - gray
- H - brown

CUT FOR FIT

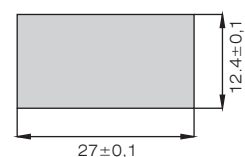

SELECTION GUIDE

□□□□□	□□□	□□□□	□□	□
Reference	frame	actuator	terminal	contact
	M1#	T1#	E3	S
	M3#	T2#		B
	M4#	T3#		Q
		T4#		G
		T5##		
		T6##		

Note: Rockers T5 and T6 have light finder. It is necessary to codify the both colors, one for rocker and one for finder.
Ex.: T5FE - Black rocker with red light finder.