

18.000 SERIES

PUSHBUTTON MICROSWITCHES

SPECIFICATIONS:

ELECTRICAL CHARACTERISTICS: 1A with resistive load 120 VAC or 0,5 A with resistive load 250 VAC (S contact).

CONTACT RESISTANCE: maximum of 20 miliohms with 1A DC.

INSULATION RESISTANCE: minimum of 1.000 megaohms.

DIELECTRIC WITHSTAND: 1000 V (rms) for 1 minute (minimum).

OPERATION TEMPERATURE: from 0°C to 55°C.

switches

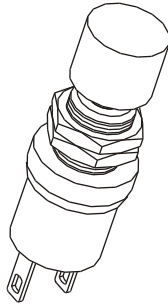

REFERENCE

18.531 - NO - contact normally opened
18.533 - NC - contact normally closed

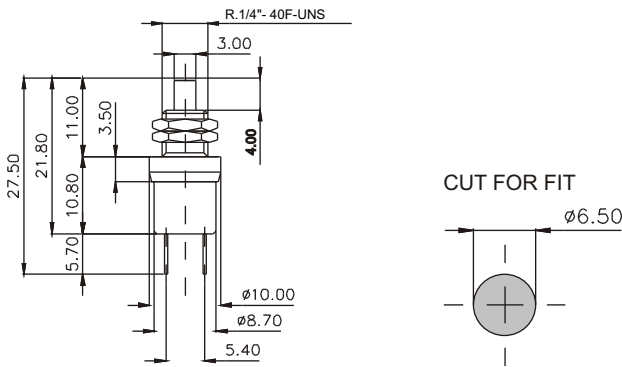

ACTUATORS

ST

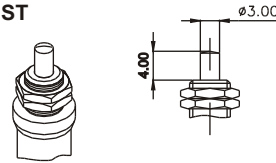

P#

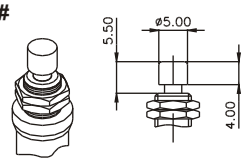

G#

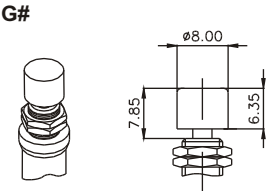

G#D

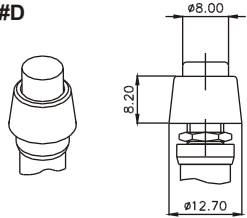

FRAMES

Frame - **L#**
 Toggle - **T3#**

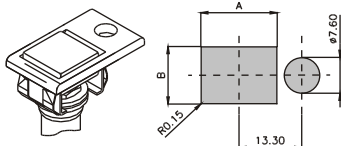

CUT FOR FIT

PANEL THICKNESS	A	B
3.18	16.2	12.2
1.9	15.8	12.2
1.20	15.4	12.2

Frame - **M#**
 Toggle - **T3#**

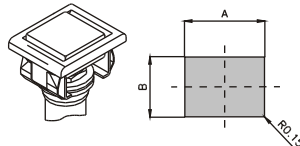

SPRING FASTENING

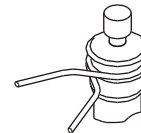

Note: Add letter M after the actuator type.
Ex: PFMSTSE

CUT FOR FIT

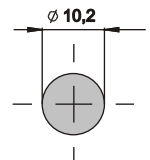

TERMINALS

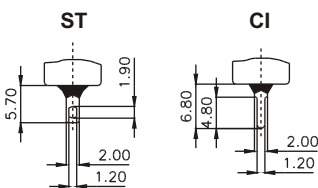

CONTACTS

S - Copper with silver plate (standard)
 1A with resistive load 120VAC
 0,5A with resistive load 250VAC

Q - Silver, copper and nickel alloy
 1A with resistive load 120VAC
 0,5A with resistive load 250VAC

G - Silver, copper and nickel alloy with gold plate
 1A with resistive load 120VAC
 0,5A with resistive load 250VAC
 0,4VA (Volt-amp) maximum, 20V maximum. (CA/CC).

- COLORS

Note: Substitute # by the code of requested color.

- A** - blue
- B** - white
- C** - yellow
- D** - green
- E** - red
- F** - black - (standard)
- G** - gray
- H** - brown

"E" SEAL

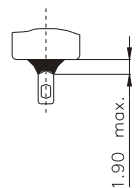

SELECTION GUIDE

Frames



Actuators

